

A121 Breakdown

Boom line filters (3)

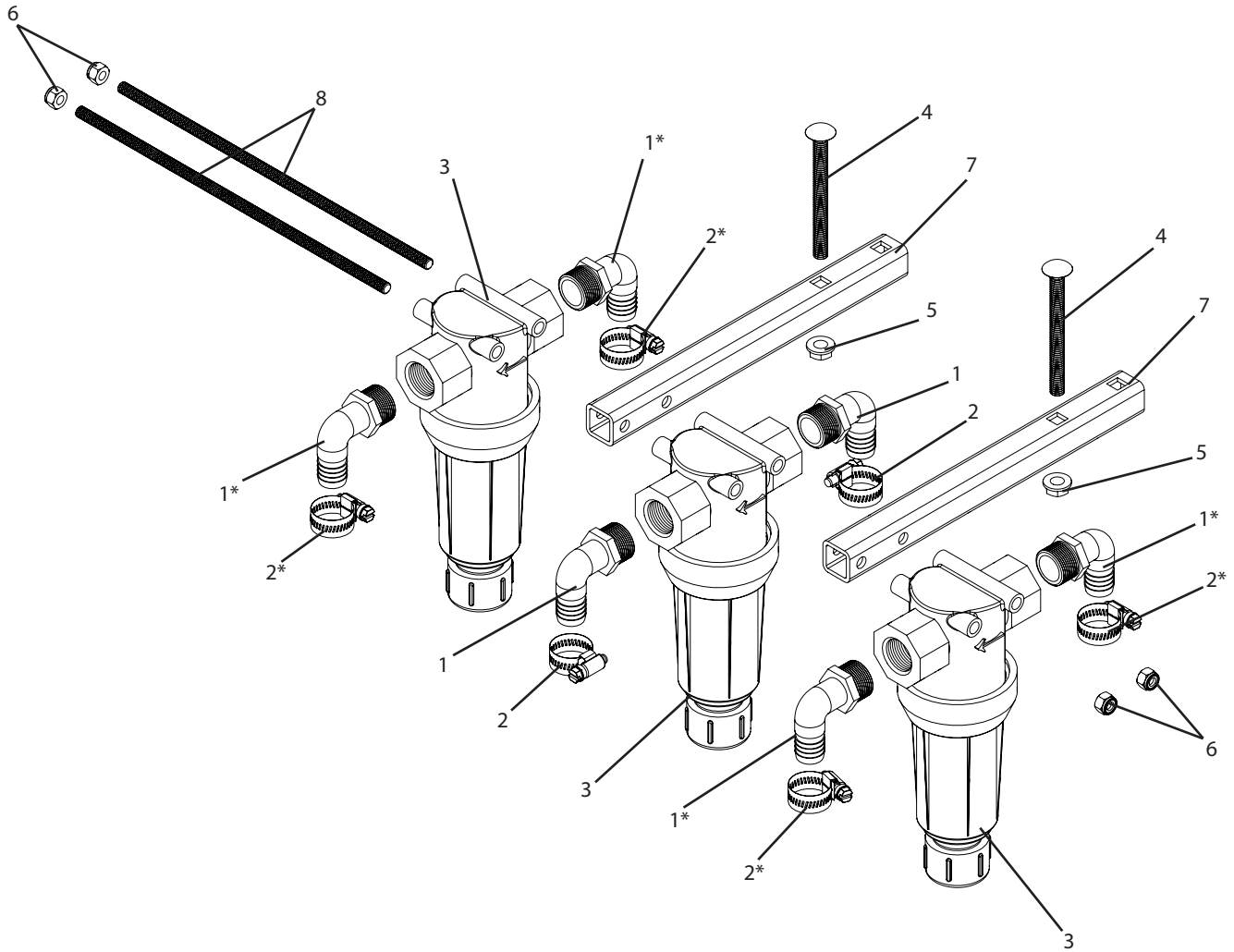

Ref#	Qty.	Part Number	Description
1	6	3EL3434 *	Adapter, Hose 90° 3/4" MPT x 3/4" HB
2	6	6812052 *	Hose Clamp, 11/16" - 1-1/4" SS
3	3	AA126ML-3-50 +	Strainer, Line 3/4" FPT 50 Mesh Screen Flush out
4	2	CB38*4G5 **	Bolt, Carriage 3/8-16 x 4" Gr 5
5	2	FN38	Nut, Flange 3/8-16
6	4	NNC516	Nut, Lock Nylon 5/16-18
7	2	T634 ***	Mounting tube, for boom line filters
8	2	TRC516*1112	Rod, Threaded 5/16-18 x 11-1/2" Zinc

* Replace (4) with 3EL3100, and (4) 6816052 when used with a 60' boom.

** Replace with CB38*3G5 when used with 30', 40', and 45' hydraulic X-fold booms.

*** Replace with T547 when used with 30', 40', and 45' hydraulic X-fold booms.

+ Has component parts breakdown available.