

## C3PT3-SC400 Breakdown

Electric solenoid valves with CropCare SC400 console, 3 sections, low pressure

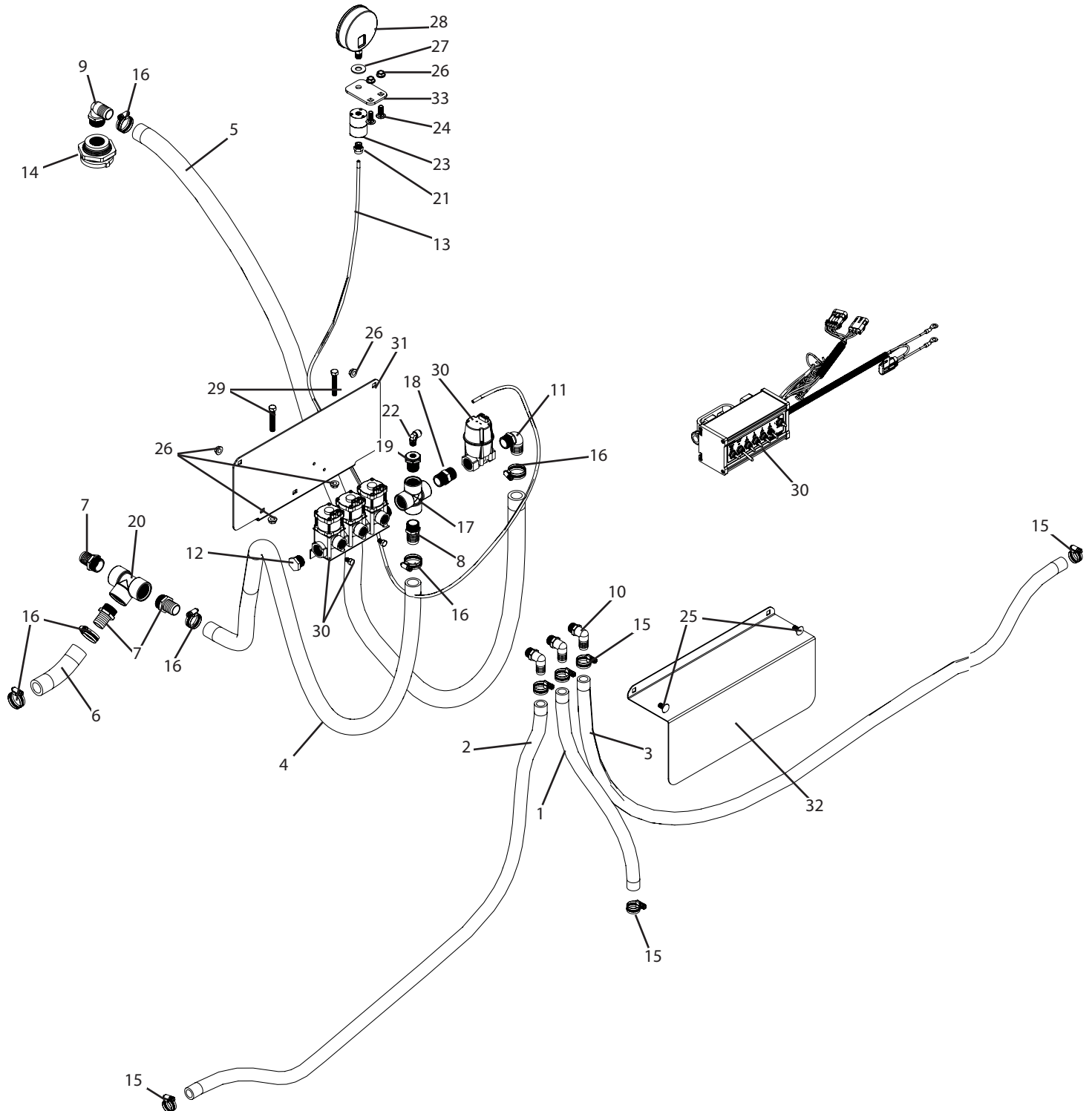

## C3PT3-SC400 Breakdown

Ref#	Qty.	Part Number	Description
1	2 FT	1012	Hose, EPDM Rubber 3/4" 300 PSI
2	5 FT	1012	Hose, EPDM Rubber 3/4" 300 PSI
3	7.084 FT	1012	Hose, EPDM Rubber 3/4" 300 PSI
4	5 FT	1016	Hose, EPDM Rubber 1" 300 PSI
5	7.5 FT	1016	Hose, EPDM Rubber 1" 300 PSI
6	0.5 FT	1016	Hose, EPDM Rubber 1" 300 PSI
7	3	3A100	Adapter, Hose 1" MPT x 1" HB
8	1	3A34100	Fitting, Hose 3/4" MPT x 1" HB
9	1	3EL100	Adapter, Hose Ell 1" MPT x 1" HB
10	3	3EL1234	Adapter, Hose 90° 1/2" MPT x 3/4" HB
11	1	3EL34100	Adapter, Hose 90° 3/4" MPT x 1" HB
12	1	3F34	Plug, 3/4" MP Poly
13	6.5 FT	5156N	Tubing, Nylon 1/4" OD Black
14	1	60427	Fitting, Bulkhead 1" FPT Dbl Tap (Requires 2-1/4" Hole)
15	6	6812052	Hose Clamp, 1/2" - 1-1/4" SS
16	6	6816052	Hose Clamp, 11/16" - 1-1/2" SS
17	1	8CR34	Cross, 3/4" FPT Sch 80 Poly
18	1	8M34	Nipple, 3/4" MPT x Close Sch 80 Poly
19	1	8RB3414	Bushing, Reducer 3/4" MPT x 1/4" FPT Sch 80 Poly
20	1	8TT100	Tee, 1" FPT Sch 80 Poly
21	1	A4MC4	Adapter, TrueSeal 1/4" MPT x 1/4" Tube
22	1	A4ME4	Adapter, TrueSeal Fitting 90° 1/4" Tube
23	1	BAAF	Isolator, Pressure Gauge 1/4" FPT
24	2	CB38*1G5	Bolt, Carriage 3/8-16 x 1" Gr 5
25	2	CB38*34G5	Bolt, Carriage 3/8-16 x 3/4" Gr 5
26	6	FN38	Nut, Flange 3/8-16
27	1	FW12S	Washer, Flat, 1/2" SS
28	1	GG1604	Gauge, 4" Liquid Filled 160 PSI
29	2	H5C38*214	Bolt, Hex 3/8-16 x 2-1/4" Gr 5
30	1	SC400-2500 *	Kit, CropCare Control Kit 4 Boom Switch
31	1	T1307	SC400 Mount, X-Fold Booms
32	1	T1308	SC400 Cover, X-Fold Booms
33	1	T1310	200-300 Gallon 3PT, Guage Mount

\* See support page for component parts breakdowns.