

CTR1-463-SC400 Breakdown

460 series manifold, 3 sections, for large trailers, with SC400 electric controls

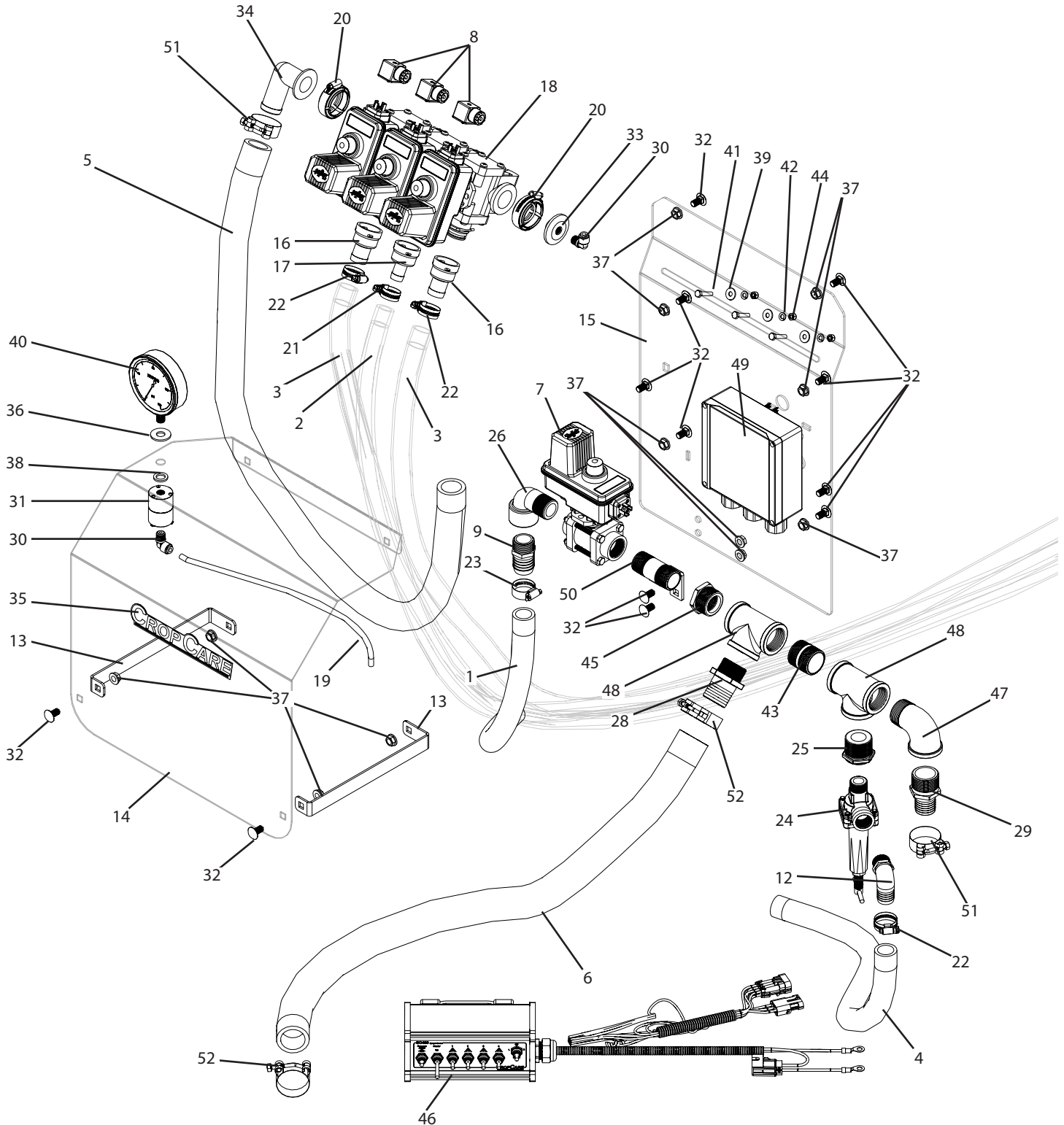

CTR1-463-SC400 Breakdown

460 series manifold, 3 sections, for large trailers, with SC400 electric controls

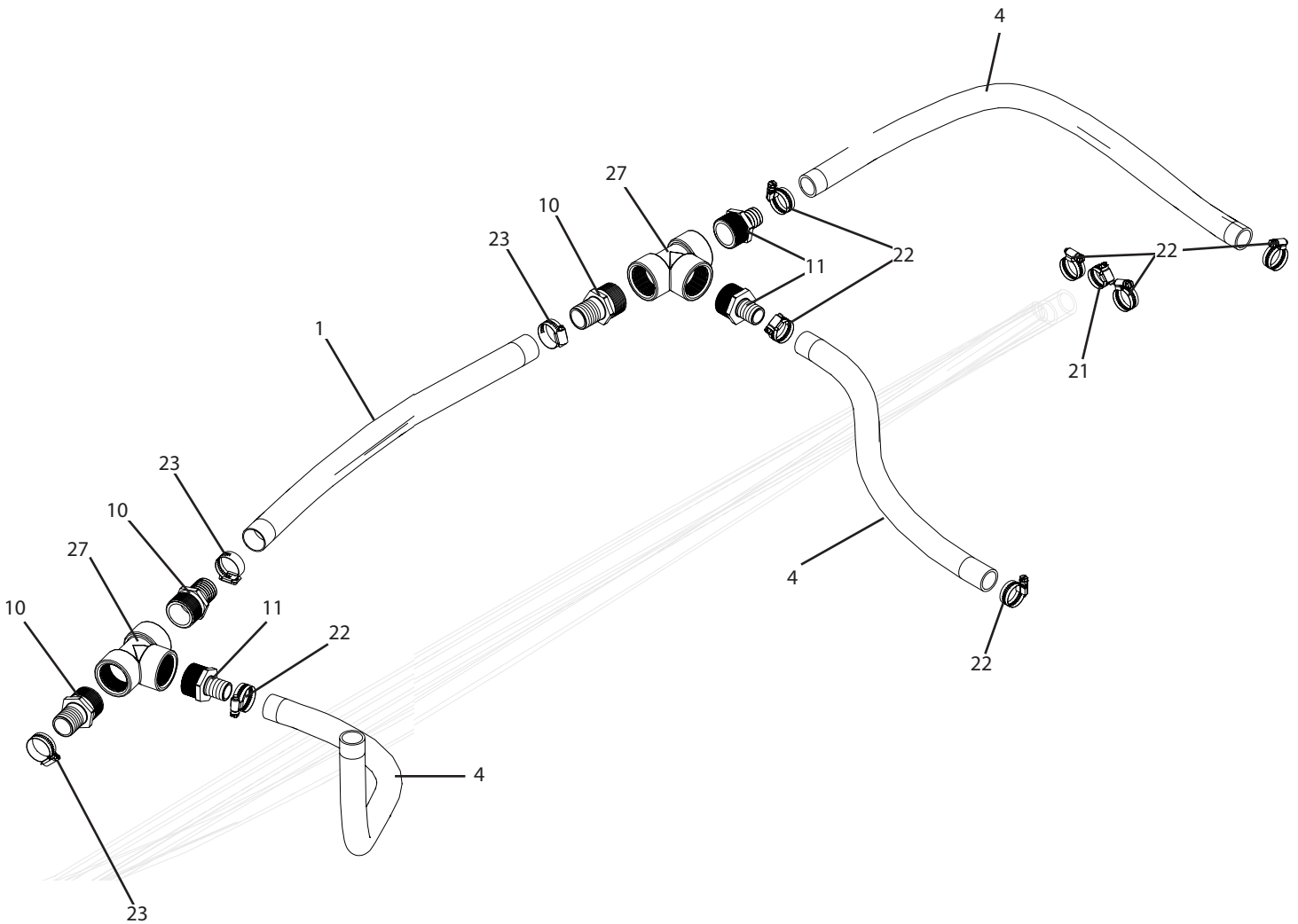

CTR1-463-SC400 Breakdown

460 series manifold, 3 sections, for large trailers, with SC400 electric controls

| Ref# | Qty. | Part Number | Description |
|------|-------|-----------------|---|
| 1 | 8 FT | 10104 | Hose, EPDM Rubber 1-1/4" 150 PSI |
| 2 | 15 FT | 1012 | Hose, EPDM Rubber 3/4" 300 PSI |
| 3 | 70 FT | 1016 + | Hose, EPDM Rubber 1" 300 PSI |
| 4 | 9 FT | 1016 | Hose, EPDM Rubber 1" 300 PSI |
| 5 | 1 FT | 1120 | Hose, Nitrile Grizzly 1-1/4" 500 PSI |
| 6 | 2 FT | 1124 | Hose, Nitrile Grizzly 1-1/2" 500 PSI |
| 7 | 1 | 344BRL-24-01C * | Valve, Regulating Ball 1" FPT 18 Second 28 GPM 2 Wire |
| 8 | 3 | 38082-15 | Cable, 4 Pin Din Connector w/1.3m 3-Wire |
| 9 | 1 | 3A100114 | Fitting, Hose 1" MPT x 1-1/4" HB |
| 10 | 3 | 3A114 | Fitting, Hose 1-1/4" MPT x 1-1/4" HB |
| 11 | 3 | 3A114100 | Adapter, Hose 1-1/4" MPT x 1" Barb |
| 12 | 1 | 3EL34100 | Adapter, Hose 90° 3/4" MPT x 1" HB |
| 13 | 2 | 450B | Brace, valve cover |
| 14 | 1 | 450C | Valve cover |
| 15 | 1 | 450MOUNT | Ball valve mounting plate |
| 16 | 2 | 45529-1 + | Fitting, QC 1" Straight HB w/Clip & O-Ring |
| 17 | 1 | 45529-3/4 | Fitting, QC 3/4" Straight HB w/Clip & O-Ring |
| 18 | 1 | 463BEC-2Q-D * | Manifold, 3-Valve #50 Flange Inlets QC Outlets DIN Connection |
| 19 | 3 FT | 5156N | Tubing, Nylon 1/4" OD Black |
| 20 | 2 | 55245-50 | Clamp, #50 Series & O-Ring Kit SS |
| 21 | 2 | 6812052 | Hose Clamp, 1/2" - 1-1/4" SS |
| 22 | 10 | 6816052 + | Hose Clamp, 11/16" - 1-1/2" SS |
| 23 | 4 | 6820052 | Hose Clamp, 3/4" - 1-3/4" SS |
| 24 | 1 | 846034 * | Valve, Relief Diaphragm Type 300PSI 3/4" NPT Fittings |
| 25 | 1 | 8RB11434 | Bushing, Reducer 1-1/4" MPT x 3/4" FPT Sch 80 Poly |
| 26 | 1 | 8SE100 | Elbow, Street 90° 1" NPT Sch 80 Poly |
| 27 | 2 | 8TT114 | Tee, Poly 1-1/4" FPT Sch 80 |
| 28 | 1 | A114112SS | Fitting, 304 SS Hose 1-1/4" MPT x 1-1/2" HB |
| 29 | 1 | A114SS | Fitting, Hose 1-1/4" MPT x 1-1/4" HB SS |
| 30 | 2 | A4ME4 | Adapter, TrueSeal Fitting 90° 1/4" Tube |
| 31 | 1 | BAAF | Isolator, Pressure Gauge 1/4" FPT |
| 32 | 12 | CB38*34G5 | Bolt, Carriage 3/8-16 x 3/4" Gr 5 |
| 33 | 1 | CP45508-1/4-PP | Fitting, Flange 1/4" FPT Gauge Port #50 |
| 34 | 1 | CP72238-PP | Fitting, Flange 90° 1-1/4" Hose Barb #50 |
| 35 | 1 | DE46 | Decal, CropCare Logo 1.9" x 8.8" |
| 36 | 1 | FW12S | Washer, Flat, 1/2" SS |
| 37 | 12 | FN38 | Nut, Flange 3/8-16 |
| 38 | 1 | FW12S | Washer, Flat, 1/2" SS |
| 39 | 3 | FW14 | Washer, Flat 1/4" |
| 40 | 1 | GG3004 | Gauge, 4" Liquid Filled 300 PSI |

* Component parts breakdowns are available for the indicated components.

+ When used on a 45ft boom, replace with 3/4" outlets (45529-3/4), hose (1012), and (4) hose clamps (6812052).

CTR1-463-SC400 Breakdown

460 series manifold, 3 sections, for large trailers, with SC400 electric controls

| Ref# | Qty. | Part Number | Description |
|------|------|-------------|---|
| 41 | 3 | H6*20M | Bolt, Hex 6mm x 20mm 1.0 Pitch |
| 42 | 3 | LW14 | Washer, Lock 1/4" |
| 43 | 1 | N114*CLS | Nipple, Pipe 1-1/4" MPT x short SS |
| 44 | 3 | NC6M | Nut, Hex 6mm x 1.0 Pitch |
| 45 | 1 | RB1141S | Bushing, Reducer 1-1/4" MPT x 1" FPT SS |
| 46 | 1 | SC400 * | Kit, CropCare Control Kit 4 Boom Switch |
| 47 | 1 | SE114S | Elbow, Street 1-1/4" NPT SS |
| 48 | 2 | T114S | Tee, 1-1/4" FPT SS |
| 49 | 1 | T403 | Control junction box, for 3 points and large trailers |
| 50 | 1 | T529 | Mounting nipple, 1" MPT x 3", stainless |
| 51 | 2 | TB163 | Clamp, T-Bolt 1-5/8"-1-7/8" (1.62"/1.87") |
| 52 | 2 | TB188 | Clamp, T-Bolt 1-7/8 -2-3/16 (1.93/2.18") |

* Component parts breakdowns are available for the indicated components.

+ When used on a 45ft boom, replace with 3/4" outlets (45529-3/4), hose (1012), and (4) hose clamps (6812052).