

ST100, ST101, ST102 Breakdown

Sight tube, 500, 750, & 1000 gallon trailers

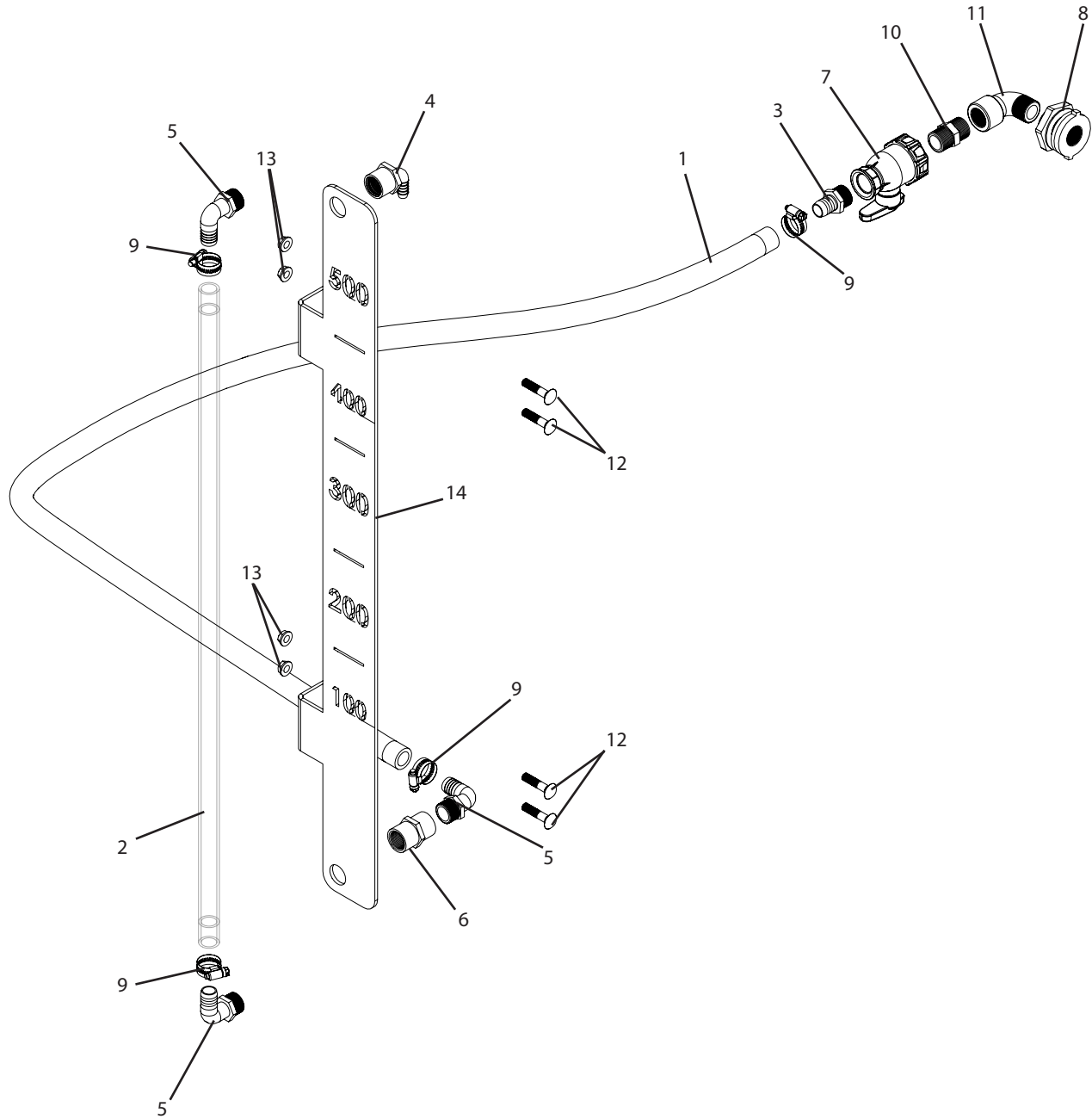

ST100, ST101, ST102 Breakdown

Sight tube, 500, 750, & 1000 gallon trailers

Ref#	Qty.	Part Number	Description
1	7 FT *	1012	Hose, EPDM Rubber 3/4" 300 PSI
2	3.167 FT **	3003	Hose, Suction 3/4" Clear PVC 100 PSI
3	1	3A3434	Fitting, Hose 3/4" MPT x 3/4" HB
4	1	3EL3412F	Adapter, Hose 90° 3/4" FPT x 1/2" HB
5	3	3EL3434	Adapter, Hose 90° 3/4" MPT x 3/4" HB
6	1	3FC34	Coupling, 3/4" FPT Poly
7	1	075SUBV	Valve, Ball Union 3/4" FPT
8	1	60401	Fitting, Tank 3/4" FPT DBL Tap (Requires a 1-7/16" Hole)
9	4	6812052	Hose Clamp, 1/2" - 1-1/4" SS
10	1	8M34	Nipple, 3/4" MPT x Close Sch 80 Poly
11	1	8SE34	Elbow, Street 90° 3/4" NPT Sch 80 Poly
12	4	CB38*134G5	Bolt, Carriage 3/8-16 x 1-3/4" Gr 5
13	4	FN38	Nut, Flange 3/8-16
14	1	T949 ***	Sight Tube, 500 Gallon

* Length is for 500-750 gallon trailers. Length is 8ft when used with 1000 gallon trailer.

** Length when used on a 500 gallon trailer. Length is 4ft when used on a 750 gallon trailer, and 4.125ft on 1000 gallon trailer.

***Reference for a 500 gallon trailer. Replace with T948 when used on a 750 gallon trailer. Replace with T950 when used on a 1000 gallon trailer.